

## 1410 FRAME & COVER

Heavy duty  
Machined bearing surfaces  
Lock lug cover

Options  
Grates

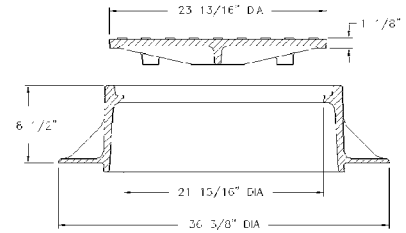

**Type M Flat Grate**  
Approx. 170 sq. in.  
open area

## V-1418-2 FRAME & COVER

Heavy duty  
Machined bearing surfaces  
Stackable frame

Options  
Custom logo covers  
Special lettered covers  
Adjusting risers  
Gasket seal covers  
Hinged unit  
Drainage grates

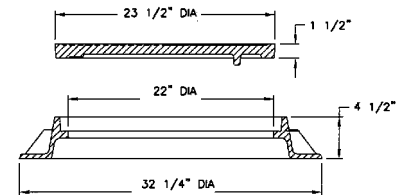

**V-3418-1 Grate**  
Approx. 169 sq. in.  
open area

Available Frames for V-1418-2 Covers and Grates

| Catalog Number | Base Flange Diameter | Frame Height |
|----------------|----------------------|--------------|
| V-1814         | 30                   | TF           |
| V-1418-3       | 30                   | 2 1/2        |
| V-1600-2       | 28 1/2               | 4            |
| V-1410-2       | 32 1/4               | 4 1/2        |
| 1348           | 32                   | 5 3/4        |

Note: All dimensions are in inches.

### Custom Logo Covers

